

Product Specification

Cylinder Mower	Qualcast	Qualcast	Suffolk Punch	Suffolk Punch
	Classic Petrol 35 S	Classic Petrol 43 S	Petrol Cylinder 14 S	Petrol Cylinder 17 S
Part number	F016 305 ...	F016 306 ...	F016 303 ...	F016 304 ...
Engine size (cm ³)	148	148	148	148
Fuel Tank capacity (l)	1.7	1.7	1.7	1.7
Rated power	2.6 kW (3.5 Hp)	2.6 kW (3.5 Hp)	2.6 kW (3.5 Hp)	2.6 kW (3.5 Hp)
Blade width (cm)	35	43	35	43
Height of cut (mm)	6 – 34	6 – 34	6 – 34	6 – 34
Cuts per metre	72	72	72	72
Grassbox capacity (l)	32	40	32	40
Weight (kg)	48	56	48	56
Max overall width (cm)	530	605	530	605
Serial Number	See rating details on machine			

Intended Use

This product is intended for domestic lawn mowing.

Introduction

This manual gives instructions on the correct assembly and safe use of your machine. It is important that you read these instructions carefully.

When fully assembled the machine weighs approximately 48 kg – 56 kg. If necessary, obtain assistance to remove from packaging.

Take care when transporting the mower to the lawn, as the blades are sharp.

Delivered Items

Carefully remove the machine from its packaging and check that you have all the following items:

- Lawnmower with handle assembly
- Operating instructions
- Machine registration card
- Engine maintenance manual
- Petrol tank
- Petrol tank screw
- Allen key
- Grassbox
- Grassbox cradle

When parts are missing or damaged, please contact your dealer.

Operating Controls

- 1 Handle top
- 2 Cutter control lever
- 3 Drive control lever
- 4 Throttle lever
- 5 Red safety latch
- 6 Petrol filler cap
- 7 Petrol tank
- 8 Carburettor
- 9 Handle bottom
- 10 Grassbox

Not all of the accessories illustrated or described are included as standard delivery.

Assembly

A Handles

Unfold the handle top **1** and secure with wing nut **12**. Make sure the cables do not become trapped between the handles.

The handle top is height adjustable. The spindle **11** can be repositioned in desired position **I**, **II** or **III**.

Use cable clips to attach cables to bottom handle **9** and top handle **1**.

Fit petrol tank to mower **7** using screw **14** and attach petrol pipe **13** to the carburettor **8** using petrol pipe clip.

Petrol

Petrol deteriorates over time. Engine starting may be difficult if you use petrol kept for more than 30 days. Always run the fuel tank dry when storing over 30 days.

1. Remove the petrol filler cap **6**, add unleaded petrol to the tank **7**, leaving approximately 6 mm of tank space for fuel expansion.
2. Replace the petrol filler cap **6**.
3. Wipe up any spilt petrol from the engine before starting the mower.

B Engine Oil

The mower is not supplied with oil in the engine, however it is possible that there is a small quantity in the engine. It is essential to fill with oil before starting the engine to avoid damage to your engine. It is important to use the recommended oil to avoid damage to your engine.

1. With the mower standing on level ground, unscrew and remove the oil filler dip stick **15**.
2. Wipe the oil filler dip stick **15** clean; refit and tighten the oil filler dip stick **15**, then remove it again. Check the oil level.
3. Add a good-quality SAE 30 API SF in small quantities at a time, allowing it to settle. Repeatedly add oil and check the level until it reaches the max. position dip stick **15**. The engine may require up to 0.6 litres of oil.
4. Refit the oil fill dip stick **15**.

C Grassbox/bag

Spring the grassbox cradle **17** into pivot holes **18**.

Attach/remove the grassbox **10** as shown.

Height of cut adjustment

Your machine has five settings which give the following approximate height of cut:

1 = 10 mm 2 = 14 mm 3 = 19 mm
4 = 27 mm 5 = 35 mm S = Scarifier

Position "S" should only be used with the Scarifier Cassette accessory (purchased separately).

To adjust the height of cut:

- Tilt the mower to take the weight off the front rollers **28**.
- Push the height of cut knob **16** in and turn to the desired position.
- For the first cutting of the season, a high cutting adjustment should be selected.

Using Your mower

Starting and Stopping

D E

Starting from Cold

1. Move the throttle lever **4** to position .
2. Move the choke lever **19** to "On".

3. Pull the recoil cord handle. Allow the recoil handle to return slowly after each pull.

Starting from Hot



Follow "Starting from Cold" using steps 1 & 3 only.

If the engine does not start or will not continue to run, follow the "Starting from Cold" procedure with choke **19** lever between the "On" and "Off" position.



Stopping

D Move the throttle lever **4** to position .

D Engaging cylinder cutter and rear roller

1. Start engine.
2. Push the red safety latch **5** forward and gradually squeeze the cutter control lever **2** towards the top handle **1**.
3. Gradually squeeze the drive control lever **3** towards the top handle **1**.
4. Release the safety button **5**.
5. Adjust the speed as required by moving the throttle lever **4** between  and .
6. To stop, release both control levers **3** and **2**.

Engaging rear roller only

1. Start engine.
2. Gradually squeeze the drive control lever **3** towards the top handle **1**.
3. Adjust the speed as required by moving the throttle lever **4** between  and .
4. To stop, release the drive control lever **3**.

Engaging cutters only

1. Start engine.
- Push the red safety latch **5** forward and gradually squeeze the cutter control lever **2** towards the top handle **1**.
2. To stop, release the cutter lever **2**.

Mowing

Before mowing, check the engine oil level and fill the petrol tank.

Toward the end of season, it is advisable to put only as much fuel in the tank as you need for each cut, since it should be completely used before storing the mower.

F For best results, place the lawnmower on the edge of the lawn, mow in a forward direction. Then at right angles at the end of each turn, slightly overlapping the previously cut strip.

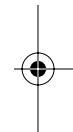
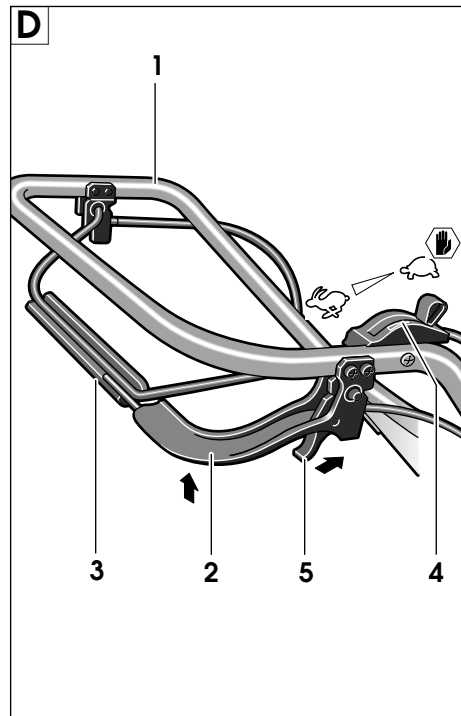
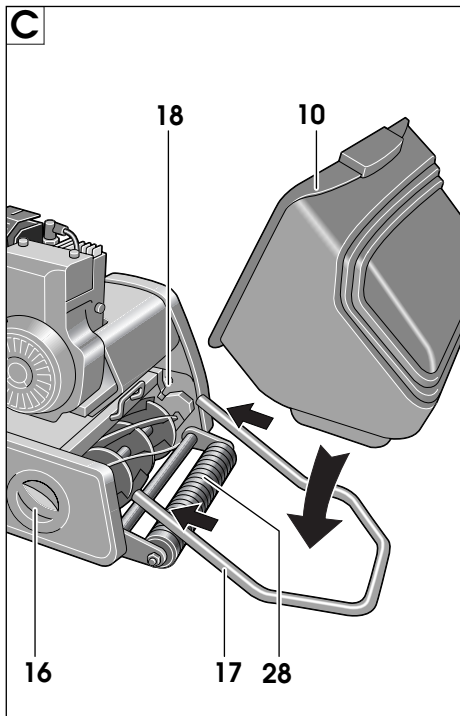
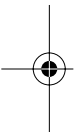
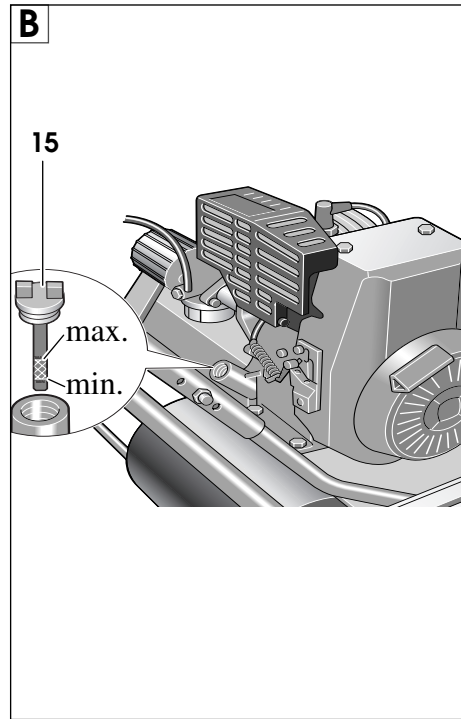
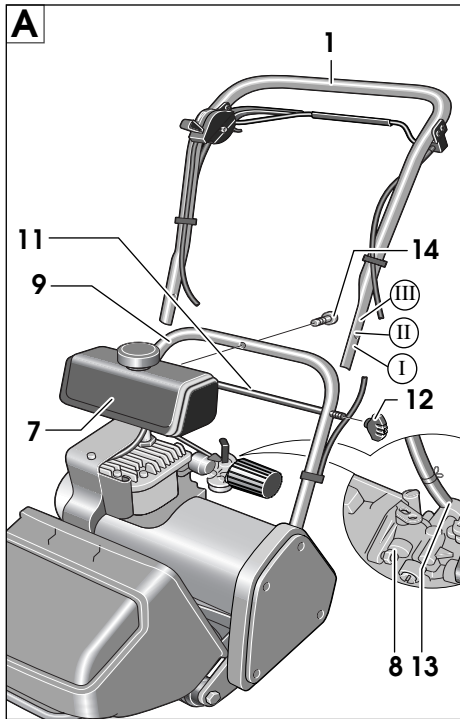

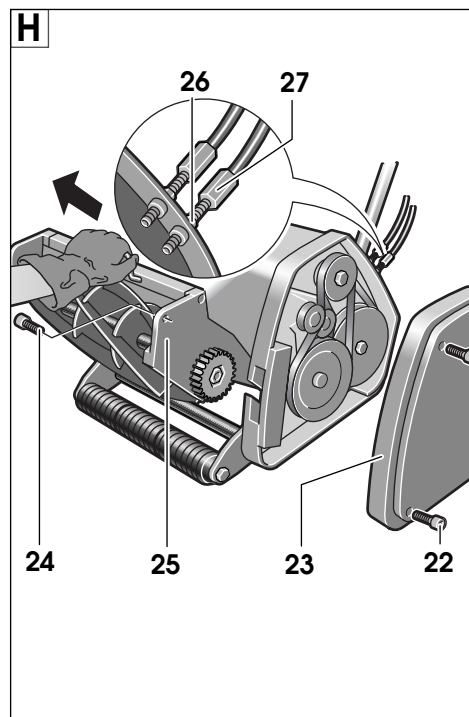
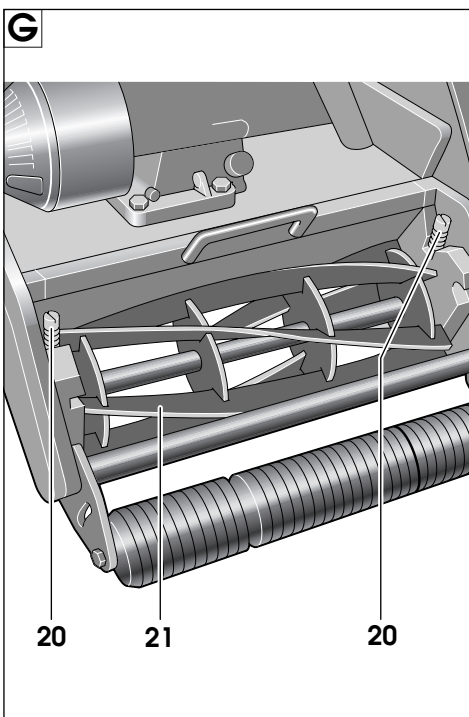
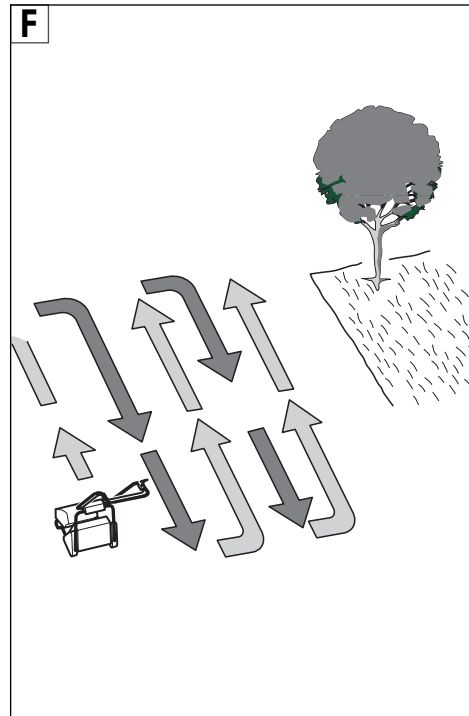
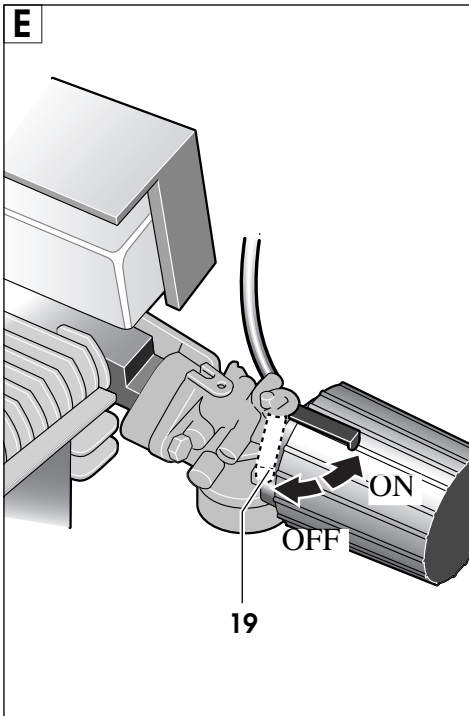



The next time you mow the lawn, try to work at right angles to the previous cut as this will help prevent unevenness in the surface soil which can build up if you always mow in the same direction.

Maintenance



Stop and remove spark plug cap.

Note: To ensure long and reliable service, carry out the following maintenance regularly.

Regularly check for obvious defects such as a loose, dislodged or damaged blade, loose fixings, and worn or damaged components.

Check that covers and guards are undamaged and correctly fitted. Carry out necessary maintenance or repairs before using.

Clean the exterior of the machine thoroughly using a soft brush and cloth. Do not use water, solvents or polishes. Remove all debris, especially from the air filter and engine fins.

If the mower should happen to fail despite the care taken in manufacture and testing, repair should be carried out by an authorised customer service agent for Atco-Qualcast garden products.

For all correspondence and spare parts orders, always include the 10-digit part number from the nameplate of the machine!

Adjusting the Blade

C G

The cutter should be adjusted if the grass is not cut cleanly and evenly.

1. Tilt the mower back and wedge securely.
2. Remove grassbox cradle **17**.
3. Turn adjuster screw **20** clockwise a little at a time.

Note: The blades are correctly adjusted when the cutting cylinder lightly brushes the bottom blade across the full width as the cylinder is turned.

The blades act like a pair of shears, as a test, correctly adjusted blades will cut a piece of good quality writing paper across the width of the blade.

Once correctly adjusted refit grassbox cradle **17**.

Removing/replacing QX Cylinder Cassette

H The mower is fitted with a QX (quick exchange) cassette which can be removed and taken to Approved Service Agent for sharpening. To remove the cassette:

- It is advisable to wear a pair of gardening gloves (not supplied).
- Remove grassbox cradle **17**.
- Remove the drive cover **23** by removing screws **22**.
- Remove cassette retaining screws **24** on both sides.
- Pull the cutting cassette unit **25** out using the handle. Obtain assistance if required.
- Refit cassette **25** following the above in reverse.

This method is the same for fitting or removing cassette accessories.

Adjusting Drive Cable

D H

If the mower doesn't drive adequately it may be necessary to adjust the drive cable as follow:

- Slacken nut **26**, turn adjuster **27** a few turns anti-clockwise.
- Retighten nut **26**.

When correctly adjusted, drive to the rear roller is engaged when the drive control lever **3** is squeezed against the handle top **1** or disengaged when released.

Engine Maintenance

Changing oil:

Change the oil after 2 hours of use. The oil should then be changed every 25 hours or at the end of each season before storage, whichever is sooner.

(See engine manual for details.)

Note: It is important that you use the recommended oil to avoid damage to your engine.

Cleaning Air filter (See engine manual for details).

General maintenance and Adjustments (See engine manual for details).

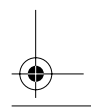
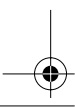
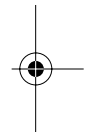
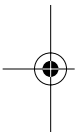

Accessories

1 litre of SAE 30 API SF Oil F016 S10258

Winter Storage/Storage over 30 day

Regular maintenance at the recommended service intervals, replacing worn or damaged parts as necessary and having the mower serviced by an ATCO-QUALCAST Approved Service Agent before winter storage will maximize the life and reliability of the mower. Observe the following before storage:

1. Clean the mower down thoroughly. Remove any grass debris especially around the engine cooling fins (also see engine manual).

2. Check the cutting action (see "Adjusting the Blades") and lightly oil the cutting edges.
3. Check that all nuts and bolts are tight.
4. Drain off any fuel in the petrol tank by:
 - Removing the pipe from the carburettor and emptying the fuel into a can.
 - Run the engine for a few minutes until the engine stops.
 - Remove the carburettor bowl by removing nut, and drain off any fuel in the carburettor. This will prevent gum (fuel deposits) forming on essential carburettor parts.
5. Change the oil and clean the air filter. (Winter storage only. See engine manual for details).

Fault Finding

The following table gives checks and actions that you can perform if your machine does not operate correctly. If these do not identify/remedy the problem, contact your service agent.

Warning: Switch off, remove spark plug cap before investigating fault.

Symptom	Possible Cause	Remedy
Mower leaves a ragged finish	Cutter not correctly adjusted	Adjust the cutter
Engine will not start	Engine is flooded Spark plug lead not connected Spark plug dirty No oil	Leave for 10–15 minutes Reconnect See engine maintenance manual Add oil
Engine stops	No petrol Engine speed too low for conditions Cutting cylinder obstructed Engine does not stop	Refill tank Move throttle Turn off engine and clear obstruction Throttle cable not correctly adjusted. Stop engine by removing spark plug lead and refer to the engine maintenance manual.
Cutting cylinder does not rotate	Incorrect adjustment	Contact an Atco-Qualcast Approved Service Agent
Land drive does not engage	Incorrect adjustment/cable damaged	Contact an Atco-Qualcast Approved Service Agent
Excessive vibration/noise	Blade(s) or/and cylinder bearing damaged Engine fault	Contact an Atco-Qualcast Approved Service Agent See engine maintenance manual

Service

Atco-Qualcast
P.O. Box 98
Broadwater Park
North Orbital Road
Denham-Uxbridge
GB-Middlesex UB 9 5HJ

☎ Service.....+44 01895 838782
Fax Service+44 01895 838789
☎ Advice line.....+44 01895 838791
Fax+44 01895 838793

Guarantee

Atco-Qualcast guarantees this product against manufacturing defects. We will repair (or replace at our option) if a manufacturing defect occurs within the guarantee period as long as it has not been subjected to rental/hire use. The engine fitted to this mower is covered by the engine manufacturer. See engine manual for details.

The guarantee period for domestic use is 3 year for parts (2 year engine) and 2 year for labour costs from date of purchase.

For the purpose of this guarantee:

Non-domestic use means all other uses including, commercial, income producing, but excluding rental/hire use.

To obtain a repair under this guarantee:

- Take your lawnmower to a Atco-Qualcast Approved Service Agent.
- Show your dated proof of purchase.
- Show the guarantee page.

This guarantee does not apply if:

- the product has been resold by original purchaser (this does not apply in the Republic of Ireland), or has been used under hire.
- the product has been modified to change the manufacturer's specification, or if non-genuine spares have been fitted.
- if any previous repair was undertaken by anyone other than an Atco-Qualcast Approved Service Agent.
- the fault is due to maladjustment, abuse, neglect or accidental damage.
- the fault is due to lack of lubrication or maintenance.

Blades, drive chains, bearings, rubber on the rear roller and cables.

The cost of routine maintenance of the product is not covered by the guarantee.

It is in your best interests to follow the Operating Instructions for your mower/scarifier, as a properly cared for product should give many years of excellent service.

Should you require spares always insist on genuine Atco-Qualcast spares. Any damage caused to the product through the fitting of parts not made or approved by Atco-Qualcast is not covered by the Guarantee.

Your statutory rights are not affected by this guarantee.

Your product has been manufactured under an environmental management system using where possible the most environmentally responsible material and processes, and with the potential for recycling at the end of its life.

When the time comes to dispose of this product please consider the environment and take it to a recognised recycling facility.

(Please contact your Local Authority for location information.)

Declaration of Conformity

Measured values determined according to 2000/14/EC (1.60 m height, 1 m distance away) and EN 25 349.

Typically the A-weighted noise level of the product is: sound pressure level 82 dB (A) (14 S/35 S), 83 dB (A) (17 S/43 S); sound power level 93 dB (A) (14 S/35 S), 94 dB (A) (17 S/43 S).

The typical weighted acceleration is 2.5 m/s².

We declare under our sole responsibility, that this product is in conformity with the following standards or standardization documents: EN 60 335, EN 836 according to the provisions of the directives 89/336/EEC, 98/37/EC, 2000/14/EC.

2000/14/EC: The guaranteed sound power level L_{WA} is lower than 95 dB (A). Conformity assessment procedure according to Annex VIII.

Notified body: SRL, Sudbury England

PLACE: Stowmarket, 11.2000

Signature:

Position: Director

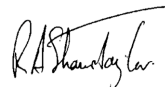

Safety Notes

Warning! Read these instructions carefully, be familiar with the controls and the proper use of the lawnmower.

Learn how to stop the lawnmower quickly in any emergency.

Explanation of symbols on the lawnmower



General hazard safety alert.



Read instruction manual.



Beware of thrown or flying objects to bystanders.



Keep bystanders a safe distance away from the machine.



Remove spark plug lead before maintenance.



Sharp blade(s). Beware of severing toes or fingers.



Wait until all machine components have completely stopped before touching them. The blades continue to rotate after the machine is switched off, a rotating blade can cause injury.

Never allow children or people unfamiliar with these instructions to use the lawnmower. Local regulations may restrict the age of the operator.

Never mow while people, especially children or pets, are nearby.

Never pick up or carry the lawnmower while the motor is running.

Keep in mind that the operator or user is responsible for accidents or hazards occurring to other people or their property.

Whilst mowing, always wear substantial footwear and long trousers. Do not operate the equipment when barefoot or wearing open sandals.

Thoroughly inspect the area where the lawnmower is to be used and remove all objects that may be thrown by the machine.

WARNING – Petrol is highly flammable.

- Store fuel in containers specifically designed for this purpose.
- Refuel outdoors only and do not smoke while refuelling.
- Add fuel before starting the engine. Never remove the cap of the fuel tank or add petrol whilst the engine is running or when the engine is hot.
- If petrol is spilled, do not attempt to start the engine but move the machine away from the area of spillage and avoid creating any source of ignition until petrol vapours have dissipated.
- Replace the fuel tank and container caps securely.
- Replace faulty silencers.
- Do not operate the engine in a confined space where dangerous carbon monoxide fumes can collect.
- Before using, always visually inspect to see that the blades, blade bolts and cutter assembly are not worn or damaged. On multi-bladed lawnmower, take care as rotating one blade cause other blades to rotate.

Mow only in daylight or in good artificial light.

Avoid operating the lawnmower in wet grass, where feasible.

Always be sure of your footing on slopes.

Walk, never run.

Mowing on banks can be dangerous:

- Mow across the face of slopes - never up and down.
- Be particularly careful of your footing on slopes or wet grass. Exercise extreme caution when changing direction on slopes. Do not mow excessively steep slopes.
- Use extreme caution when stepping back or pulling the lawnmower towards you. Never cut grass by pulling the mower towards you.

Stop the blades if the lawnmower has to be tilted for transportation when crossing surfaces other than grass and when transporting the lawnmower to and from the area to be mowed.

Do not tilt the lawnmower when starting or switching on the motor, except if the lawnmower has to be tilted for starting in long grass. In this case, do not tilt it more than absolutely necessary and lift only the part which is away from the operator. Always ensure that both hands are in the operating position before returning the mower to the ground.

Never operate the lawnmower with defective guards, or without the grassbox in place.

Do not change the engine governor settings or overspeed the engine. Operating an engine at excessive speed may increase the hazard of personal injury.

Disengage all blade and clutches before starting the engine.

Start the engine or switch on the motor carefully according to instructions and with feet well away from the blade(s). Do not tilt the mower when starting.

Do not put hands or feet near, or under, rotating parts while the lawnmower is being operated.

Stop the engine and disconnect the spark plug wire:

- before checking, cleaning or working on the lawnmower
- after striking a foreign object. Inspect the lawnmower for damage and make repairs before restarting and operating the lawnmower.
- if the lawnmower starts to vibrate abnormally (check immediately).
- before making height of cut adjustment

Stop the engine:

- whenever you leave the machine
- before refuelling
- before clearing blockages
- before making height of cut adjustment

Reduce the throttle setting during engine shut-down.

Keep all nuts, bolts and screws tight to be sure that the lawnmower is in safe working condition.

Replace worn or damaged blades and bolts in sets to preserve balance.

Never store the lawnmower with petrol in the tank inside a building where fumes may reach open flame or spark.

Allow the engine to cool before storing in any enclosure.

To reduce the fire hazard, keep the engine, silencer, battery compartment and petrol storage area free of grass, leaves or excessive grease.

Check the grassbox/bag frequently for wear or deterioration.

Replace worn or damaged parts for safety.

Go slow when using a trailing seat.

If the fuel tank has been drained, this should be done outdoors.

Be careful during adjustment of the lawnmower to prevent entrapment of the feet and hands between moving blades and fixed parts of the lawnmower.

Ensure replacement parts fitted are Atco-Qualcast approved.

QUALCAST

Bosch Engineering



PETROL CYLINDER MOWER OPERATING INSTRUCTIONS